

Wildlife and Countryside Act 1981

Definitive Map and Statement of Public Rights of Way for Oxfordshire

The Oxfordshire County Council
South Leigh and High Cogges Bridleway No. 30 Modification Order 2024

This Order is made by the Oxfordshire County Council under section 53(2)(b) of the Wildlife and Countryside Act 1981 ('the Act') because it appears to that authority that the Definitive Map and Statement of Public Rights of Way for Oxfordshire require modification in consequence of the occurrence of an event specified in sections 53(3)(c)(ii) of the Act, namely, the discovery by the authority of evidence which (when considered with all other relevant evidence available to them) shows: -

that a highway shown in the map and statement as a highway of a particular description ought to be there shown as a highway of a different description.

The authority has consulted with every local authority whose area includes the land to which the order relates. The Oxfordshire County Council hereby orders that: -

1. For the purposes of this order the relevant date is 8 March 2024.
2. The Definitive Map and Statement of Public Rights of Way for Oxfordshire shall be modified as described in Part I and Part II of the Schedule and shown on the map attached to the Order.
3. This order shall take effect on the date it is confirmed and may be cited as the Oxfordshire County Council South Leigh and High Cogges Bridleway No. 30 Modification Order 2024.

Dated this 8th day of April 2024

THE COMMON SEAL OF THE OXFORDSHIRE COUNTY COUNCIL
was hereto affixed in the presence of:-

K. Jordan

County Solicitor/Designated Officer



18/24

SCHEDULE

PART I Modification of Definitive Map

Description of path or way to be upgraded

Existing Path Number	Existing Status	Proposed Status and Number	Description of Route	Width
30	Footpath	Bridleway 30	From the road at High Cogges Farm at grid reference SP 3749 0904 (point A on the Order plan) leading generally southwest for approximately 865 metres, past the eastern end of Footpath No. 28 and via SP 3731 0890 (point B) to Tar Road, SSW of Springhill Farm, at SP 3688 0847 (point C).	6.1 metres (20 foot inclosure award)

PART II Modification of Definitive Statement Variation of particulars of path or way

Statement for South Leigh and High Cogges to be amended

Number	Status	Description	Width	Conditions & Limitations
30	BR	From the road at High Cogges Farm leading SW past FP 28 to Tar Road, SSW of Springhill Farm.	6.1 metres (20-foot inclosure award)	-

The Oxfordshire County Council, South Leigh & High Cogges Bridleway No. 30 Modification Order 2024

436750 437000 437250 437500 437750

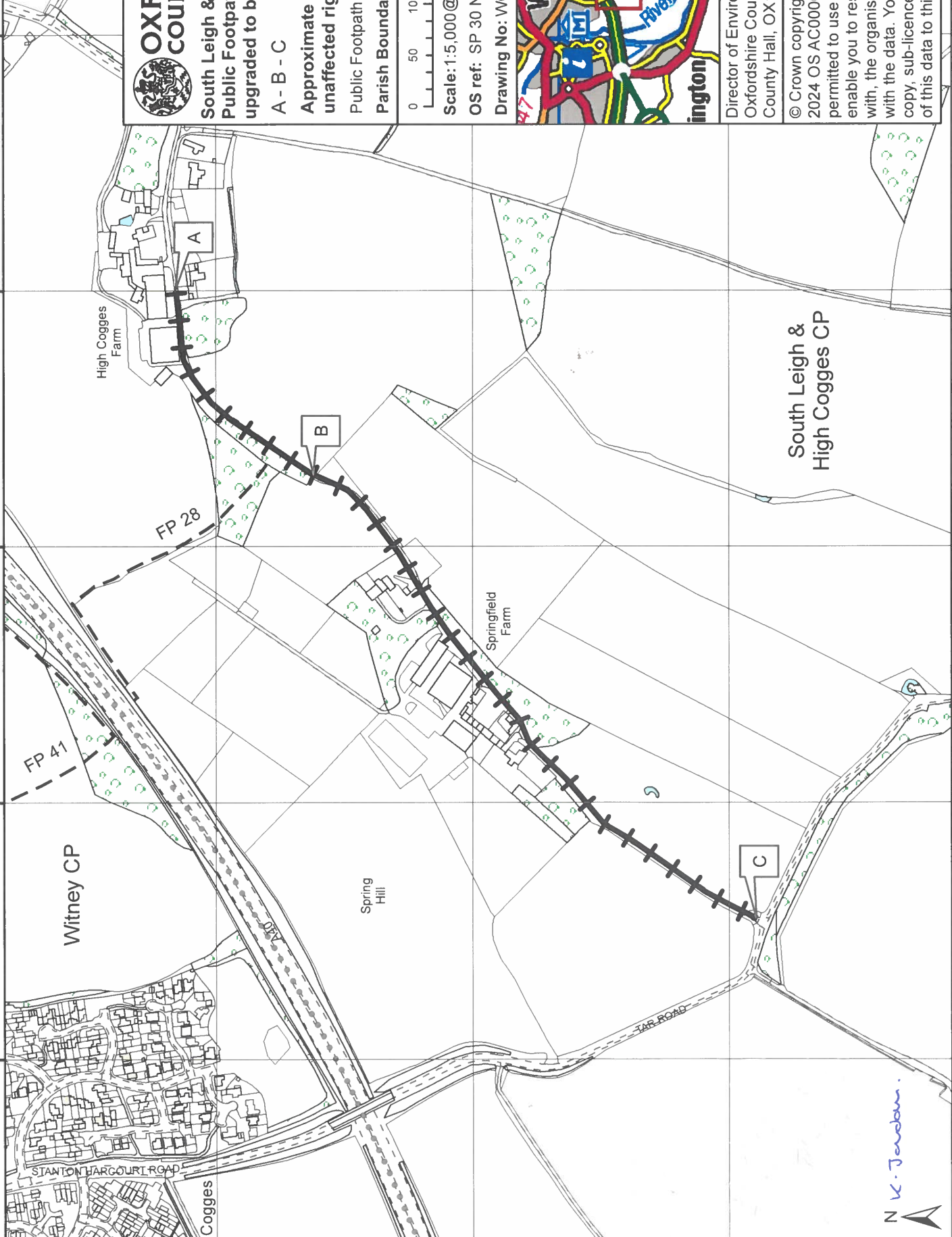

**OXFORDSHIRE
COUNTY COUNCIL**

South Leigh & High Cogges
Public Footpath No. 30 to be
upgraded to bridleway

- A - B - C
- Approximate route of
unaffected rights of way
- Public Footpath
- Parish Boundary



Scale: 1:5,000 @ A4 Date: 26/02/2024
OS ref: SP 30 NE Drawn by: CC
Drawing No: WCA81s53 / 743a / 03711

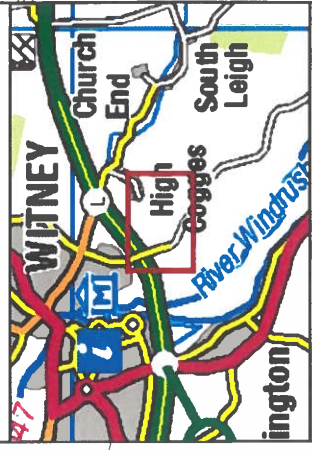

Director of Environment and Place
Oxfordshire County Council
County Hall, OX1 1ND

© Crown copyright and database rights
2024 OS AC0000851087. You are
permitted to use this data solely to
enable you to respond to, or interact
with, the organisation that provided you
with the data. You are not permitted to
copy, sub-licence, distribute or sell any
of this data to third parties in any form.

South Leigh &
High Cogges CP

N N.K. Jordan

436750 437000 437250 437500 437750

209000

208750

208500

209000

208750

208500

